



FFF 79 Rampart Road, Salisbury, Wiltshire, Wiltshire, SP1 1HU

Recently redecorated two bed maisonette over 2 floors close to Salisbury City Centre. Gas CH. Permit parking.

- TWO BEDROOM MAISONETTE OVER 2 FLOORS
- CLOSE TO SALISBURY CITY CENTRE
- GAS CENTRAL HEATING
- RECENTLY REDECORATED
- COUNCIL TAX BAND A
- EPC-D

£850 PCM

Ground Floor
Approx. 36.2 sq. metres (390.2 sq. feet)

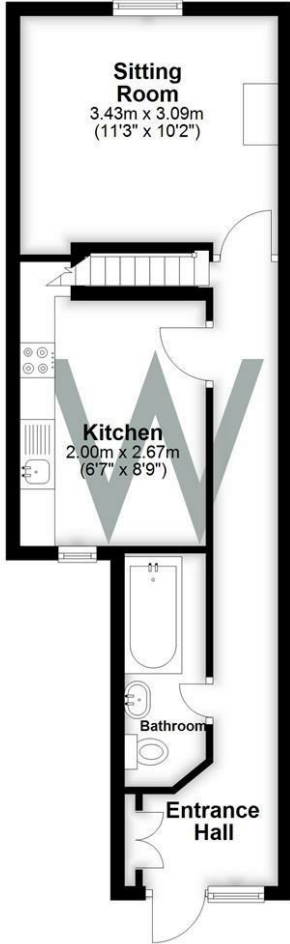

First Floor
Approx. 21.1 sq. metres (227.3 sq. feet)

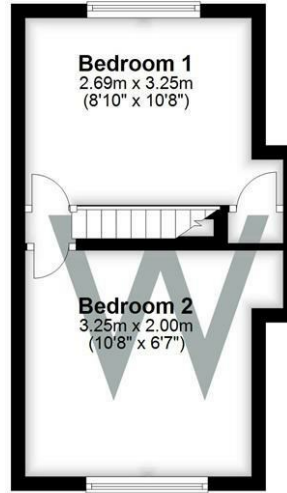

WHITES

Castle Chambers, 47 Castle Street, Salisbury,
Wiltshire, SP1 3SP
Tel: 01722 336422/Option 2
www.hwwhite.co.uk
email: lettings-management@hwwhites.co.uk

Energy Efficiency Rating	Current	Potential
Very energy efficient - lower running costs		
(92 plus) A		
(81-91) B		
(69-80) C		
(55-68) D		
(39-54) E		
(21-38) F		
(1-20) G		
Not energy efficient - higher running costs		
England & Wales	EU Directive 2002/91/EC	73

Environmental Impact (CO ₂) Rating	Current	Potential
Very environmentally friendly - lower CO ₂ emissions		
(92 plus) A		
(81-91) B		
(69-80) C		
(55-68) D		
(39-54) E		
(21-38) F		
(1-20) G		
Not environmentally friendly - higher CO ₂ emissions		
England & Wales	EU Directive 2002/91/EC	